

FORM NO. 1.

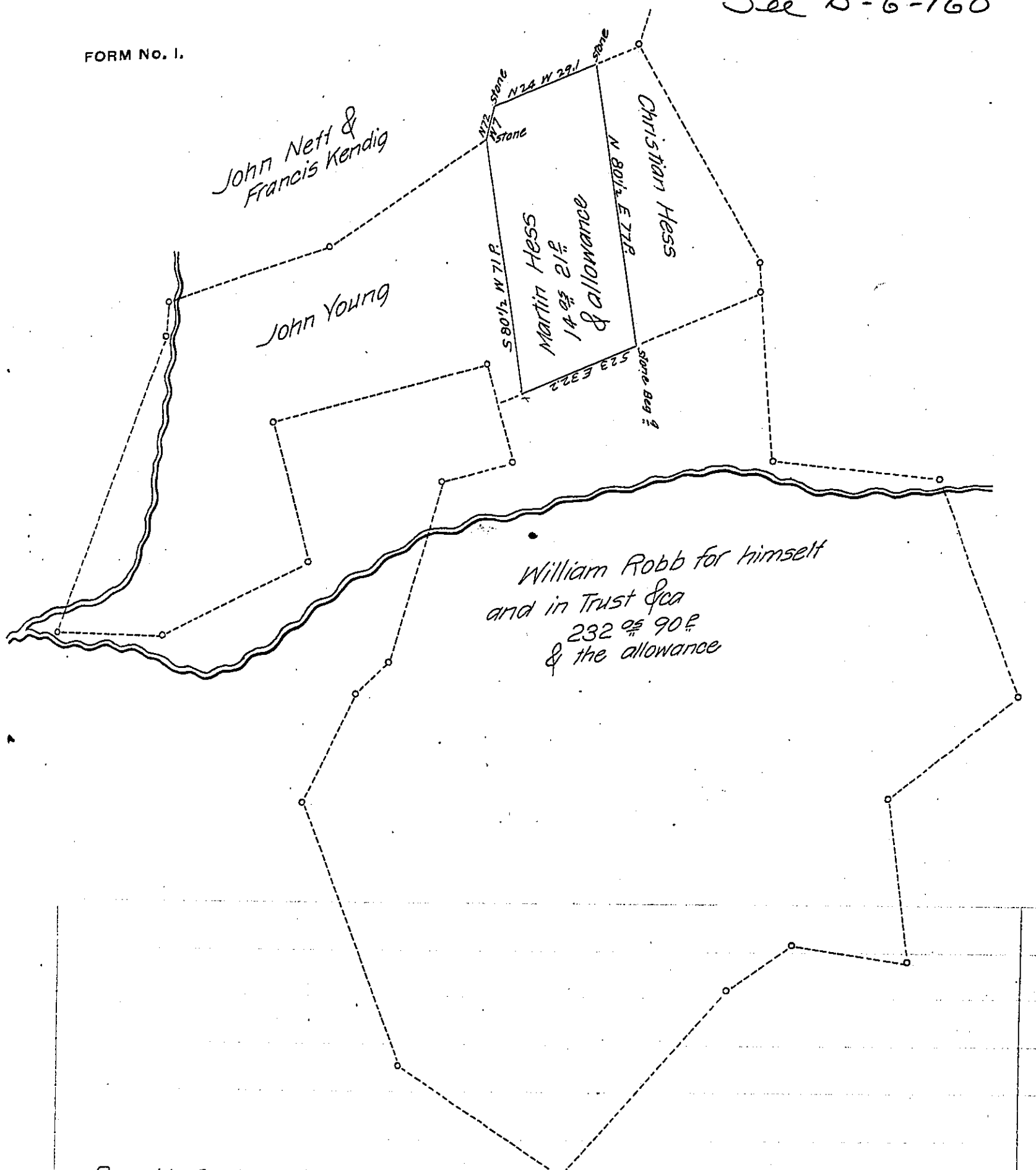

Draught of a piece of Land Situate in Drumore Township Lancaster County Containing Fourteen acres twenty one perches and the usual allowance of 6 P Cent &c. Being part of a Tract Containing 232 ac 90 P. & all <sup>as</sup> in pursuance of a Warrant granted to the said Wm Robb for himself and in Trust for the Heirs of John Robb deceased <sup>Dated 26<sup>th</sup> March 1812.</sup> Surveyed the above described piece of Land for Martin Hess July 16<sup>th</sup> 1822. Examined & certified the 25<sup>th</sup> Day of July AD 1822

To Saml Cochran Esq<sup>r</sup> Robt King Jr. D.S.

Surveyor Genl

IN TESTIMONY that the above is a copy of the original remaining on file in the Department of Internal Affairs of Pennsylvania, made conformably to an Act of Assembly approved the 16th day of February, 1833, I have hereunto set my Hand and caused the Seal of said Department to be affixed at Harrisburg, this second day of October 1906

*Geo A. Brown*  
Secretary of Internal Affairs.